



2025-26 Mite Managers Information

AGEND

A

- Ice Scheduling and Trading
- SAHA & USA Hockey Registration Requirements
- SAHA Gambling
- Off Ice Events & Opportunities
- Team Funds
- Season Operations



ICE SCHEDULING & TRADES

John Celski | SAHA Ice
Scheduler

ice@stillwaterhockey.net



SCHEDULED ICE

Ice times added to team calendars by SAHA's Ice Scheduler should NOT be edited/updated or deleted by anybody other than our Ice Scheduler!!!



- In the event a SAHA scheduled ice time requires updating, contact our Ice Scheduler to request the change be made!
 - If replacing a practice with a scrimmage, our Ice Scheduler will ensure locker rooms are assigned for both teams. ice@stillwaterhockey.net

SCHEDULED ICE

- SAHA's ice scheduler (ice@stillwaterhockey.net) will update each team's calendar with SAHA scheduled ice times.
- All ice times booked by SAHA are contracted and paid for and are therefore the responsibility of the team to use.
- Ice that has been scheduled by the ice scheduler counts towards that team's allocated 25-26 SAHA provided ice hours. If a team is unable to use the ice that is scheduled for them, they will not receive additional ice in it's place.
- If a team is unable to use a scheduled ice time, they can try to trade their practice time with another team.

UNUSABLE ICE

- Mites/U8s should not trade outside of their level
 - Mite/U8s 3s may trade with 4s and vice versa
- Use the [Ice Trade Process](#) (subpage of the Manager's Corner) if you are unable to use your scheduled ice time
 - **Follow step by step instructions** for posting available ice.
- Email managers about available ice time
 - A Mite Manager contact list will be available on the Ice Trades page of the website or on the [Mite/U8 Managers Contact](#) subpage or Managers Corner
- Click "View All" below ice trades calendar to see what ice has been posted
 - Be on the lookout for ice listed as "GIFT." Gift ice is up for grabs – first come, first serve.

 TIP 
If unable to use half/shared ice, check with the other team first. If you share ice at another time, try trading your half to them now in exchange for their half next time. 😊



USA HOCKEY & SAHA REQUIREMENTS

Jeanette Geisbaver | SAHA Registrar

registrar@stillwaterhockey.net





2020-2021 Official Team Roster



All sanctioned practices, scrimmages and games which this team may participate in are expected to be conducted in compliance with local, state and federal health guidelines and regulations in force at the time and location of the activity.

Original Approval: Tue Oct 13 2020 14:20:41 Central Daylight Time
Last Updated: Tue Oct 13 2020 14:21:10 Central Daylight Time
Approved by: RAKNESS, RICH

Program: MNH0206

Association: STILLWATER AREA HOCKEY ASSOCIATION

Team: Stillwater Girls 12U B1 Black

Team ID: MNH0206-031

Classification: MN Girls 12U USAH 14U

Category: Travel Division: B

Players (12)

Last Name	First Name	Jersey #	Position	DOB	DOB Verification	SafeSport	Transfer	Zip
CUNNINGHAM	WYNTER	H 1 A 1	Goalie	05/2008	Verified	Not Applicable	N/A	55038
DONNAY	NATALIE	H 9 A 9	None	03/2008	Verified	Not Applicable	N/A	55082
GOSSAI	ANNIKA	H 11 A 11	None	05/2009	Verified	Not Applicable	N/A	55082
HOWE	ADELYN	H 16 A 16	None	03/2008	Verified	Not Applicable	N/A	55082
KNOWLAN	CHLOE	H 14 A 14	None	10/2008	Verified	Not Applicable	N/A	55042
PETERSON	ETTA	H 6 A 6	None	06/2009*	Verified	Not Applicable	N/A	55082
PETERSON	RUBY	H 10 A 10						
SEEGER	AYLA	H 5 A 5						
SIMONET	AUDREY	H 3 A 3						
STUMPF	SEDONA	H 13 A 13						
TURSSO	FAITH	H 12 A 12						
WHISLER	GABRIELLA	H 15 A 15						

PETERSON	ETTA	H 6 A 6	None	08/2009*	Verified	Not Applicable	N/A	55082
PETERSON	RUBY	H 10 A 10	None	05/2008	Verified	Not Applicable	N/A	55082
SEEGER	AYLA	H 5 A 5	None	01/2009	Verified	Not Applicable	N/A	55003
SIMONET	AUDREY	H 3 A 3	None	06/2008	Verified	Not Applicable	N/A	55082
STUMPF	SEDONA	H 13 A 13	None	05/2008	Verified	Not Applicable	N/A	55082
TURSSO	FAITH	H 12 A 12	None	07/2009*	Verified	Not Applicable	N/A	55082
WHISLER	GABRIELLA	H 15 A 15	None	10/2008	Verified	Not Applicable	N/A	55082

Redlined Players (1)

Last Name	First Name	Jersey #	Position	DOB	DOB Verification	Transfer	Zip
SWETT	ECHO	H 2 A 2	None	02/2008		N/A	55129

Redline Comments: DOB/CIT Verification

Note: Redlined players are not approved for game play. Please see comments for reasoning.

Staff (3)

Last Name	First Name	Position	Card Number	Level Certified	Certification Expires	Module	SafeSport	Screening
CUNNINGHAM	LANCE	Head Coach	0000485200	3	12/31/2021	PW12	Verified	Completed
Email: LANCE.CUNNINGHAM@GMAIL.COM Phone: (612) 226-7996								
DONNAY	RYAN	Assistant Coach	0000438426	3	12/31/2020	PW12	Verified	Completed
Email: LEONARD97_@HOTMAIL.COM Phone: (763) 807-8212								
HOWE	MATTHEW	Assistant Coach	0000139819	4	12/31/20**	PW12	Verified	Completed
Email: MAHOWE13@GMAIL.COM Phone: (612) 568-5555								

* Indicates player's age is below the team's classification range. ** Indicates player's age is above the team's classification range.

MANAGER SPECIFICS

- All Managers **MUST** register with [SAHA](#) and [USA Hockey](#) as volunteers.

Use links provided above or on the [Managers Corner](#) page of the SAHA website

When finished with USA Hockey & SAHA registrations, email admin@stillwaterhockey.net to gain team website and app admin access.

- All Managers **MUST** :

1) Complete [SafeSport Training](#) EVERY year.

2) Complete a [Background Screening](#) every other year.

Use links provided above or on the [Managers Corner](#) page of the SAHA website

COACHING SPECIFICS

- Coaches cannot be added to a roster until ALL of the following are completed:
 - Registered with SAHA and USAH
 - Background Screening cleared
 - Appropriate Age Level Modules are completed
 - SafeSport Training is verified as completed
- Coaches who do not complete all necessary requirements by Dec. 31 will be redlined for the remainder of the season and will not be able to continue coaching in 25-26.

QUESTIONS ABOUT ROSTERS & COACHES?

CALL / TEXT / EMAIL

Jeanette Geisbauer

- 612.978.2901
- registrar@stillwaterhockey.net

Do yourself a favor and put this number in your phone now.

(It's hard to find when you're in the lobby of some outstate rink after you realize you don't have your roster url 😊.)



CHARITABLE GAMBLING

Patrick Budion | Gambling Manager
gamblingmanager@stillwaterhockey.net



SAHA GAMBLING LOCATIONS

- We are in 7 sites
 - Lakewoods Tavern
 - Muddy Cow Oak Park Heights
 - No Neck Tony's
 - Ziggy's on Main
 - River Siren Brewing
 - The Current
 - Keys Cafe in Stillwater



- Top 5 Targets:
 - Hook and Ladder
 - Cozzie's
 - Woody's
 - Brian's
 - Sal's

SAHA GAMBLING INFO TO KNOW

- You **cannot** accept a sponsorship from any entity that holds a gambling license of their own (ie. Bayport Legion, Stillwater American Legion, etc.)
- You **cannot** hold a raffle (you can hold an auction)
- Due to the success of our gambling efforts, not one SAHA registration level fee increased this season – most actually went down while some stayed the same!!
- We are always looking to get into new locations. If you have suggestions, contact gamblingmanager@stillwaterhockey.net



OFF ICE EVENTS & OPPORTUNITIES

Paula Walther | Director of Off-Ice Operations

off.icedirector@stillwaterhockey.net



SAHA MITE TEAM PHOTOS

Stillwater Middle School - Cafeteria

- Monday, Dec. 1 : 4:30p-8:30p

Stillwater Middle School - Cafeteria

- Tuesday, Dec. 2: 4:30p-8:30p

*Times will be assigned



FUNDRAISER

BACK BY
POPULAR
DEMAND



What: Heggies Pizza Fundraiser

Who: Those who are interested in offsetting your individual hockey fees. Not everyone on the team needs to participate

When: Starts Friday, October 17 – November 23

Order and Money Collection: ~November 24

Delivery Date: Monday, December 8th

Additional Information and order form: <https://www.stillwaterhockey.net/fundraising>



TEAM FUNDS

Collin Bushman | SAHA Treasurer

treasurer@stillwaterhockey.net



LEVEL FEES

- Mite/U8 level 3 and 4 teams owe an additional fee to SAHA
 - Fees offset higher operating costs for those levels including more ice time and jamborees
 - **Level fees SHOULD NOT be a surprise.** They are clearly noted on the registration page of the website AND are agreed to at the time of registration.

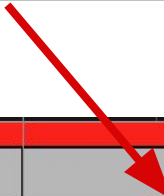

Category	Level	Base Registration Fee	Level Fee	Total Payable to SAHA (Base Registration + Level Fee)
Mite/U8	termites	\$ 290.00		\$ 290.00
Mite/U8	Level 1	\$ 345.00		\$ 345.00
Mite/U8	Level 2	\$ 635.00		\$ 635.00
Mite/U8	Level 3	\$ 670.00	\$ 165.00	\$ 835.00
Mite/U8	Level 4	\$ 635.00	\$ 200.00	\$ 835.00
Squirt	B2/C	\$ 1,649.00		\$ 1,649.00
Squirt	B1	\$ 1,649.00	\$ 55.00	\$ 1,704.00
Squirt	A	\$ 1,649.00	\$ 200.00	\$ 1,849.00
PeeWee	C	\$ 1,759.00		\$ 1,759.00
PeeWee	B2	\$ 1,759.00		\$ 1,714.00
PeeWee	B1	\$ 1,759.00	\$ 75.00	\$ 1,834.00
PeeWee	A	\$ 1,759.00	\$ 105.00	\$ 1,864.00
PeeWee	AA	\$ 1,759.00	\$ 325.00	\$ 2,084.00
Bantam	B2/C	\$ 2,034.00		\$ 2,034.00
Bantam	B1	\$ 2,034.00	\$ 20.00	\$ 2,054.00
Bantam	A	\$ 2,034.00	\$ 20.00	\$ 2,054.00
Bantam	AA	\$ 2,034.00	\$ 105.00	\$ 2,139.00
U16 Boys		\$ 1,714.00		\$ 1,714.00
JG	B	\$ 1,754.00		\$ 1,754.00
JG	A	\$ 1,879.00		\$ 1,879.00
10U	B1/B2	\$ 1,754.00		\$ 1,754.00
10U	A	\$ 1,754.00	\$ 45.00	\$ 1,799.00
U12	B1	\$ 1,769.00		\$ 1,769.00
U12	A	\$ 1,769.00	\$ 40.00	\$ 1,809.00
U15 Girls	B1	\$ 1,719.00		\$ 1,719.00
U15 Girls	A	\$ 1,719.00	\$ 65.00	\$ 1,784.00
U19	A	\$ 1,139.00		\$ 1,139.00

LEVEL

FEES

Levels Fees WILL NOT be collected via SportsEngine invoicing.

Level fees will be collected at Picture Night

- It would be VERY HELPFUL if managers can help with overseeing level fee collection.
 - Please collect fees in advance from team OR help communicate with families they should bring level fees on picture night.
 - Families not able to attend picture night should give team fees to manager in advance.

TEAM

FEES

- Teams may choose to collect an additional fee to be used for team expenditures (ie. tournaments/jamborees, team apparel, additional ice, team meals, coaches gifts, etc)
- **Be Transparent** : Create and share a budget and breakdown with families at the start of the season. Provide updates during the year so families know how money is being spent.
- Team funds (from families or sponsorships) are to be used for **team** related expenses ONLY.
- **TEAM FEES ARE GETTING TOO HIGH!!**
 - **Keep It Reasonable** : Avoid over-collecting "just in case." Collect what you need and know – don't make assumptions for future unknowns.
- Any remaining team fees at the end of the season should be divvied up evenly amongst all players and distributed to families

Please Review - SAHA Team Manager Best Practices: Team

Fees



SEASON OPERATIONS

Jen Zanon | Admin

admin@stillwaterhockey.net



SPORTS ENGINE

SportsEngine App: Parents must be a "guardian" on the player's SportsEngine profile to access app features such as RSVP or Chat.

- Should a parent need guardian acces, you can help by:

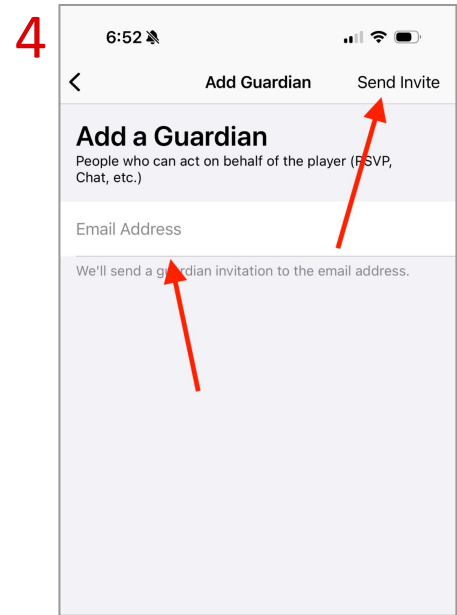
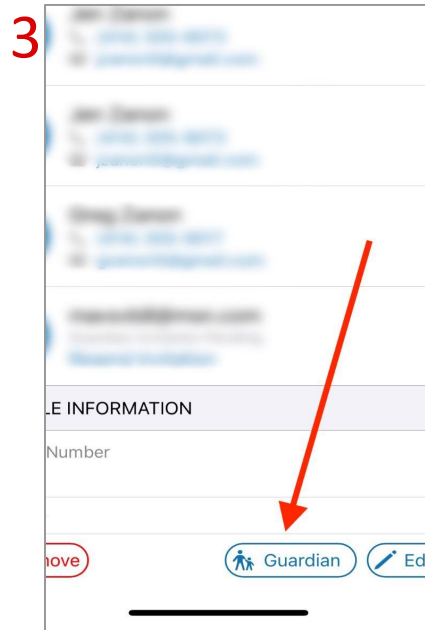
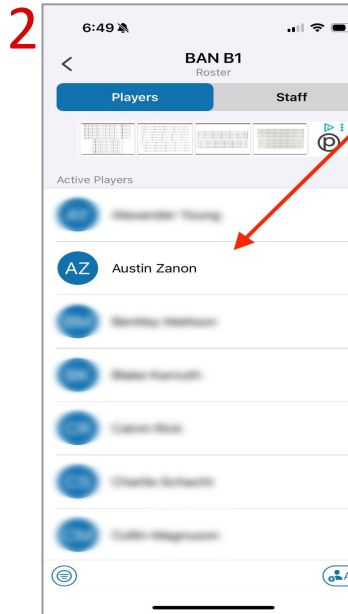
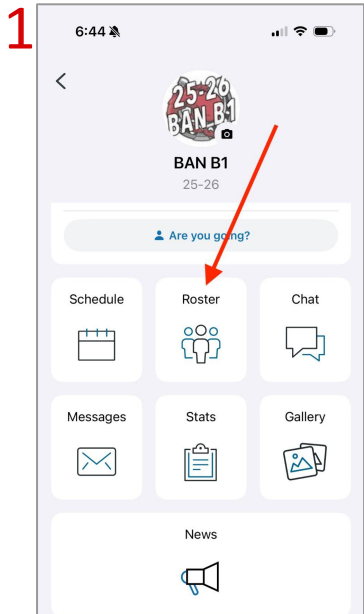

SPORTS ENGINE

SCAM ALERT

SCAMMERS LOVE SPORTSENGINE!!

...especially, this feature 

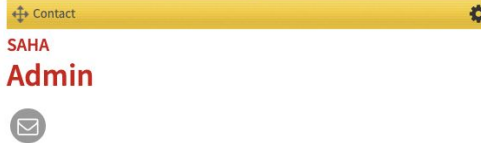

- Consider posting your email address without a link
- Matt Tuccitto (SAHA President) will **NOT** contact you via email.
 - If necessary, Admin will contact you via admin@stillwaterhockey.net on his behalf.

LOCKER ROOM SUPERVISION POLICY

"One coach ("Supervising Coach") shall be present in the locker room when players are present at all times. The Supervising Coach shall make sure that the locker room is free from hazing, rough-housing and verbal abuse. Swearing in the locker room is strictly prohibited. The Supervising Coach shall also make sure that no photos are taken in the locker room. The only cell phone use that is permitted is use of the phone to play music. Other use is absolutely prohibited.

Violation of any of these rules may lead to reprimand, suspension and/or termination from team participation."

SAHA's locker room policy is available on the [Rules and Policies](#) page of the SAHA website (subpage of Governance/Board).

LOCKER ROOM SUPERVISION POLICY

Locker Room Monitors must be the same gender as the team.

- Should a team not have a coach of the same gender available to supervise the locker room, a Volunteer Locker Room Monitor is needed.
- All Locker Room Monitors must be registered with USAH & SAHA. Background Checks and SafeSport Training must also be completed.

Scrimmages / Tournaments

- Managers/Teams are responsible for scheduling scrimmages and Tournaments
 - Thanksgiving Classic: Mites 3&4 - Covered by SAHA
 - Skate for the Roses: U83&4 - Covered by SAHA
- Tournaments do not need to be approved by SAHA
- End of Year Jamboree: 3/6-8 (all levels)
 - More information to come in next month

REACH OUT FOR SCRIMMAGES AND TOURNAMENTS EARLY!!!!



[Stillwaterhockey.net > Resources > Managers Corner](#)