

CREVE COEUR ICE ARENA – LOCKER ROOM USE PLAN

The following layout of the ice rink shows the flow to better separate the players and spectators who are coming and going for scheduled ice times. Anyone using the locker rooms will need to use the temporary exit at the West End of the ice rink.

Please avoid going back into the lobby.

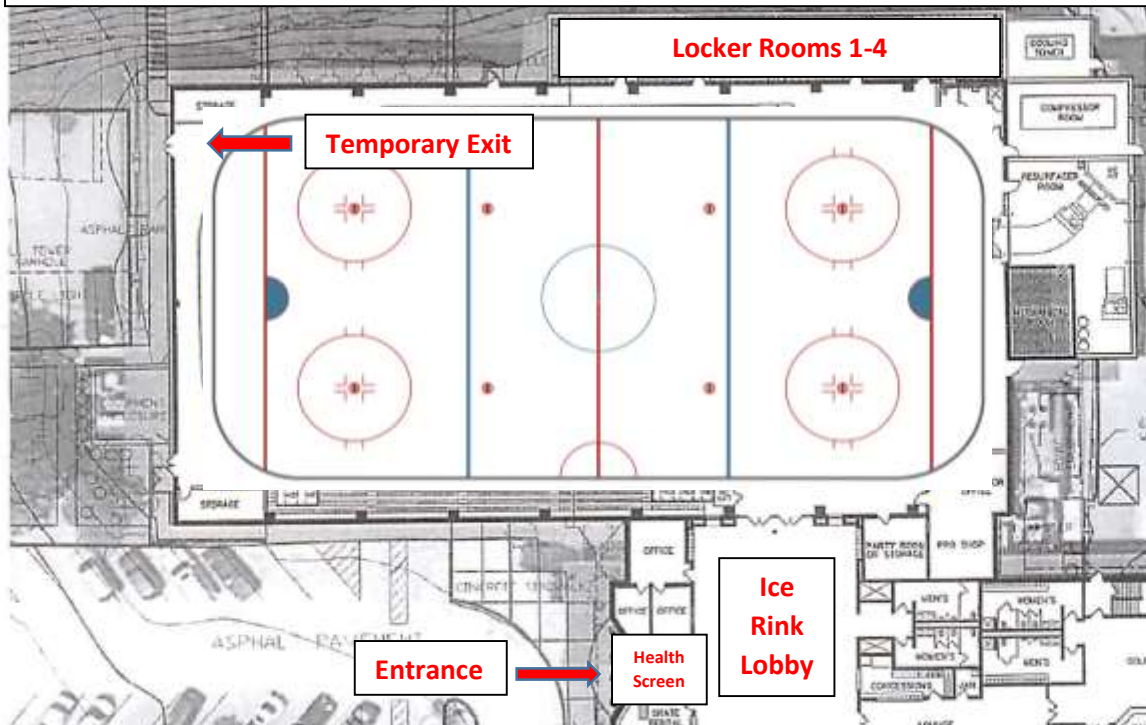

LOCKER ROOM

The following must be followed if you are using the locker room:

- Max 10 players.
- Masks must be worn at all times.
- 6-Foot Social distancing is required.
- Door must be propped open at all times.
- Restroom/shower must remain locked.
- Come as dressed as you can. Use the lobby restroom for anything less than a t-shirt and shorts.
- Arrive up to 30 min. before your ice time.
- Exit 15 min. after your ice time.
- Exit through the new temporary exit at the end of the ice rink, past the player's benches. Follow the arrows.

This plan is in place with the approval of St. Louis County and the City of Creve Coeur. If not followed, players will be asked to leave and teams will lose their contracted ice time for the future...we are in this together!

Plan is to use all four locker rooms with the posted guidelines to the right. Please review the guidelines and share with your team, especially the one regarding...

Come as dressed as you can.

Use the lobby restroom for anything less than a t-shirt and shorts.

You are using the locker rooms if your team has a star ★ in your time slot on the Locker Room Use Schedule.

Health screens must still take place upon entering the building, even if you are using the locker rooms.