

How to Create an Account on WCPSS Athletics

Step 1: Go to <https://www.wakecountyathletics.com>

Step 2: Click **Create an Account** at the top of the page.



Step 3: Fill in the required fields

A screenshot of the SportEngine account creation form. The form has a white background with the SportEngine logo at the top. Below the logo, it says 'Fill out the following information to create your SportEngine account.' There are three input fields: 'Email Address', 'First Name', and 'Last Name'. Each field has a small red arrow pointing to it.

Passwords must be at least 8 characters in length and must contain at least one uppercase letter, one lowercase letter, and one number or symbol.

Step 4: Click **Sign up for your Sport Ngin Account**. An activation email will be sent to the email address used to create the Sport Ngin account. If you do not see the email within a couple of minutes, be sure to check your Spam/Junk folder.

Open the activation email and click on the activation link. This will bring you back to the website where you can successfully log in to your NGIN account.

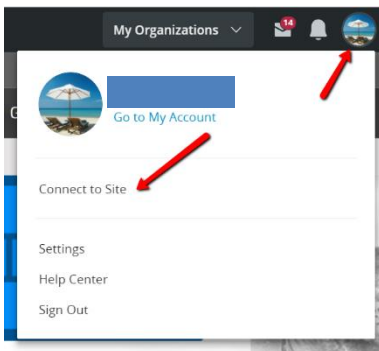

Step 5: Log into the website with your username and password. Click on your icon in the top right corner. The click "connect to site" tab.

ONCE ALL STEPS ARE DONE EMAIL SUPPORT@NASATHLETICS.COM TO GAIN ACCESS TO YOUR PAGE.

Need help registering? email: support@nasathletics.com