

the Centennial

BUSINESS. PLEASURE. SPOKANE.

Whether here for business, pleasure or both, travelers will be inspired and fascinated by Spokane's iconic historic landmarks, creative culture and trademark charm.



NEARBY ATTRACTIONS

- Riverfront 100 acre park
- Spokane River
- Centennial Trail
- River Park Square Mall
- INB Performing Arts Center
- Spokane Arena
- Spokane Convention Center
- Cork District
- Ale Trail
- Golf Courses
- Adventure Sports
- 50+ restaurants within walking distance



The Centennial is the destination for both social and professional events. Overlooking the Spokane River, our event space contains 30,000-sq. ft. and accommodates up to 1,300 guests.

Ballrooms to Boardrooms to Room Blocks. Large or intimate events. Whether you are a professional event planner, a team parent or you've been tasked with the family reunion this year, you'll find an unparalleled level of comfort when you host at the Centennial.

LOCATION

The Centennial is conveniently located on the north bank of the Spokane River, just steps across the footbridge from Riverfront, our city's illustrious 100-acre park. 15 minutes from Spokane, arrive or depart from Spokane International Airport.

ROOMS

400 guest rooms located in the heart of Spokane. Kick back and rest easy on our pillow-top beds, stay connected with lightning-quick complimentary wi-fi, catch a movie on our big flat screen TVs. Our rooms also include microwaves and refrigerators.

DINING

Experience fresh, regionally inspired Northwest cuisine at the Centennial restaurant, serving breakfast, lunch and dinner daily. Our riverside summer patio is perfect for sipping a delicious cocktail and listening to some of the region's best musicians on the weekends. Our Espresso bar serves artisan coffee, beverages, along with grab-and-go items. Catering available upon request.

SERVICES

Same-day valet laundry service, business center, coffee bar and self-parking. Our Fitness Zone on the seventh floor elevates your workouts and offers unparalleled views of the city while you exercise. Cruise the Centennial Trail along the Spokane River or venture into city proper with our custom cruiser bike rentals for all hotel guests.

TRANSPORTATION

We offer complimentary transportation within a two mile radius of the hotel, as well as to and from Spokane International Airport. Uber Taxi service is also readily available.



MEETING & CATERED EVENTS

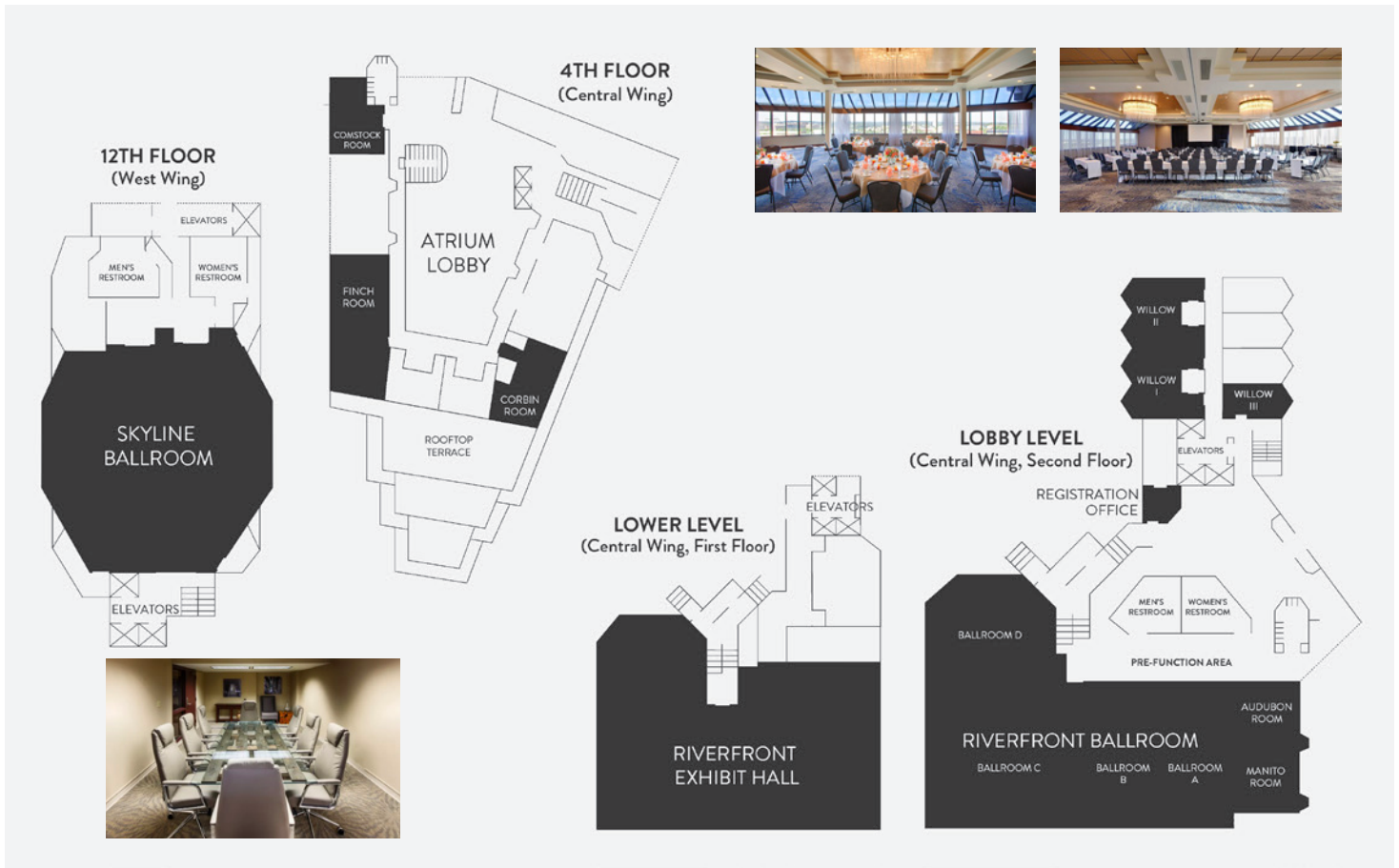

capacity

The Centennial offers flexible space for meetings and other catered events.

30,000 total square feet of meeting space available for up to 1,300 attendees.

ROOM	DIMENSIONS	SQUARE FEET	THEATER	CLASSROOM	BANQUET ROUNDS	CONFERENCE	U-SHAPE	BOARD ROOM
Skyline Ballroom	62' x 70' x 12-16'	4,143	300	180	240	-	48	-
Skyline I & II	62' x 34' x 12-16'	2,087	125	90	96	42	36	-
Riverfront Ballroom	141' x 60' x 11.5'	9,800	1,200	500	600	-	-	-
Audubon Room	25' x 27' x 11.5'	649	45	30	24	18	15	-
Manito Room	25' x 27' x 11.5'	649	45	30	24	18	15	-
Ballroom A & B	60' x 28' x 11.5'	1,680	120	81	104	46	48	-
Ballroom C	60' x 60' x 11.5'	3,600	300	216	224	52	84	-
Ballroom D	32' x 45' x 11.5'	1,499	120	72	88	36	48	-
Cannon Hill Room	29' x 19' x 9'	460	50	30	32	20	22	-
Comstock Room	29' x 19' x 9'	460	50	30	32	20	22	-
Finch Room	47' x 24' x 9'	932	80	45	48	30	24	-
Corbin Room	36' x 24' x 9'	774	50	33	40	24	18	-
Willow I & II	26' x 15' x 11.5'	423	35	24	32	20	21	-
Willow III	24' x 12' x 7-8'	290	-	-	-	-	8	-
Riverfront Exhibit Hall	116' x 75' x 8.5'	8,000	800	300	400	-	-	-